

PARADE ROUTE FOR THE
62ND ANNUAL SOUTHERN MARYLAND VOLUNTEER FIREMEN'S CONVENTION

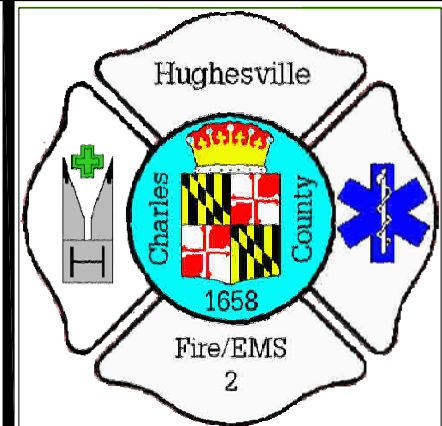

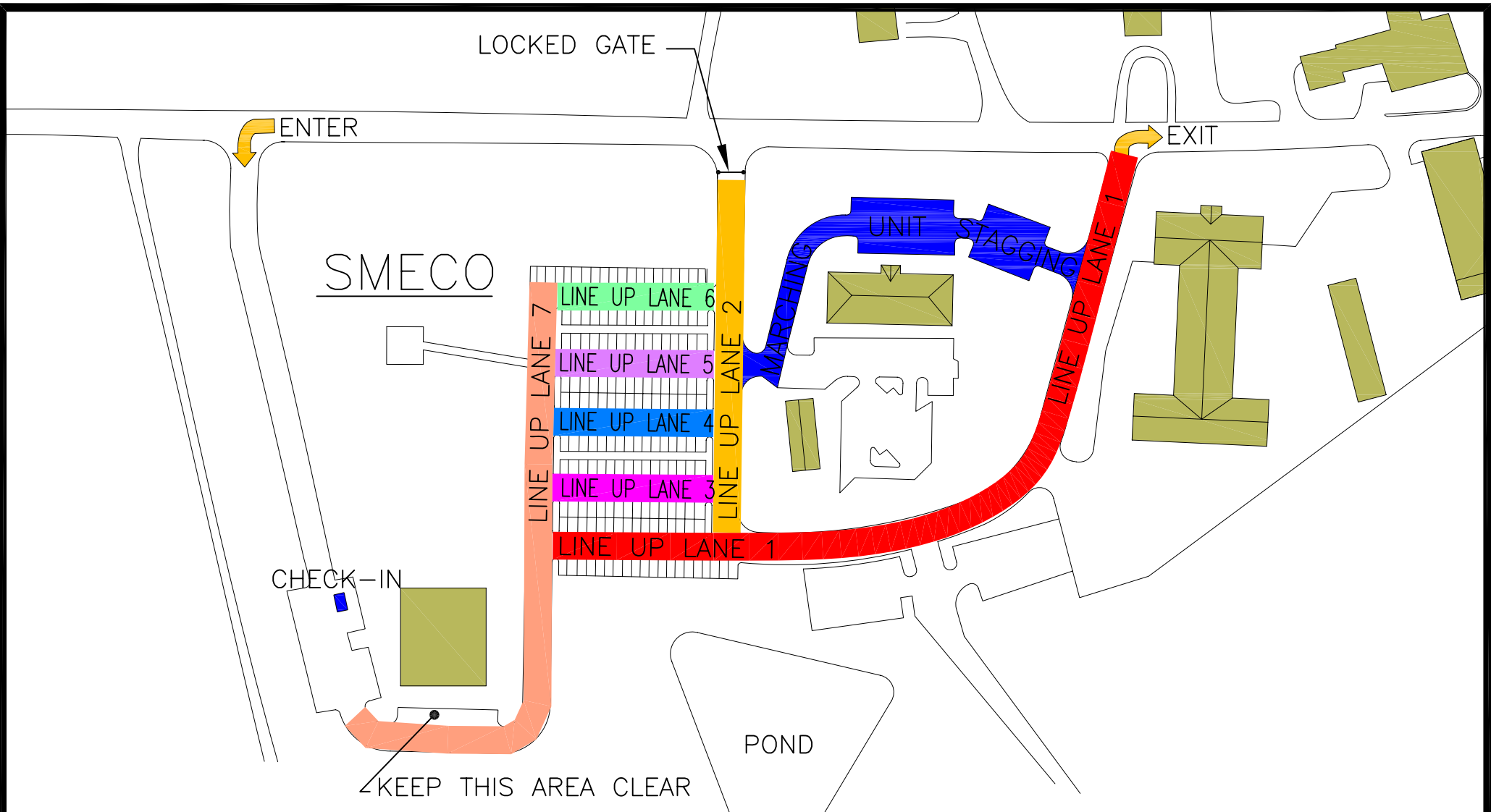

APPARATUS STAGGING FOR THE
62ND ANNUAL SOUTHERN MARYLAND VOLUNTEER FIREMEN'S CONVENTION

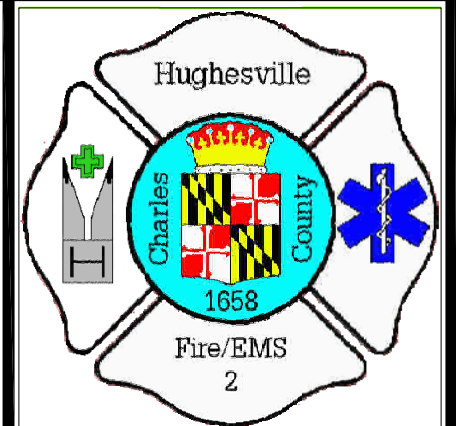

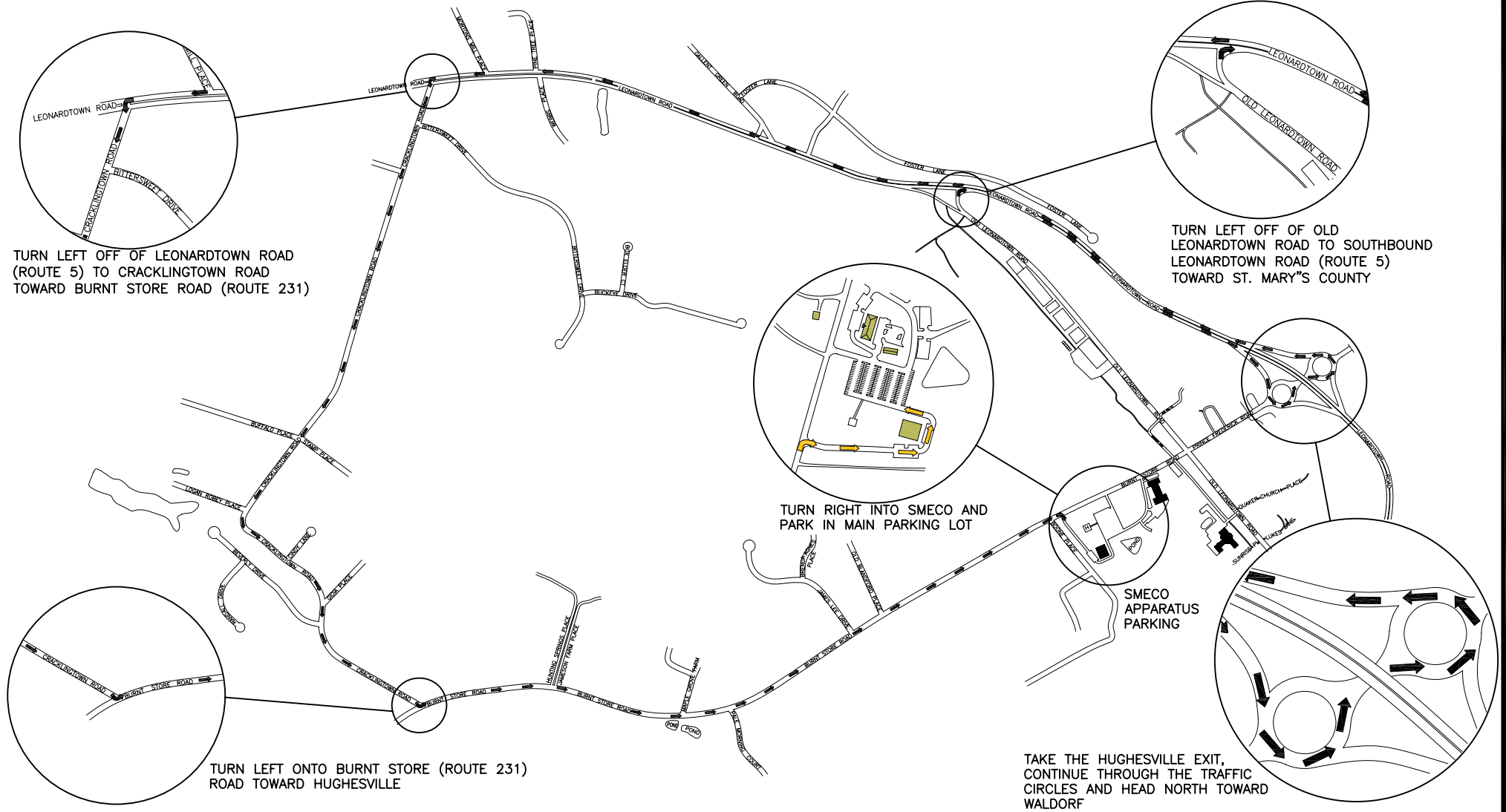

APPARATUS PARKING FOR THE
62ND ANNUAL SOUTHERN MARYLAND VOLUNTEER FIREMEN'S CONVENTION

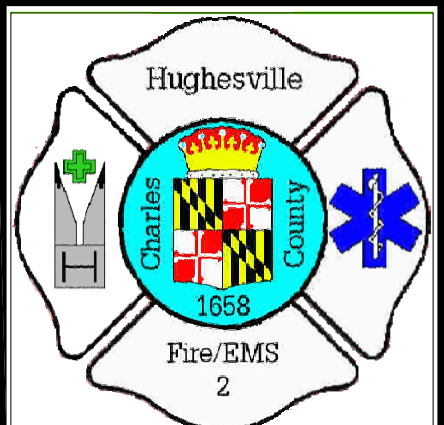

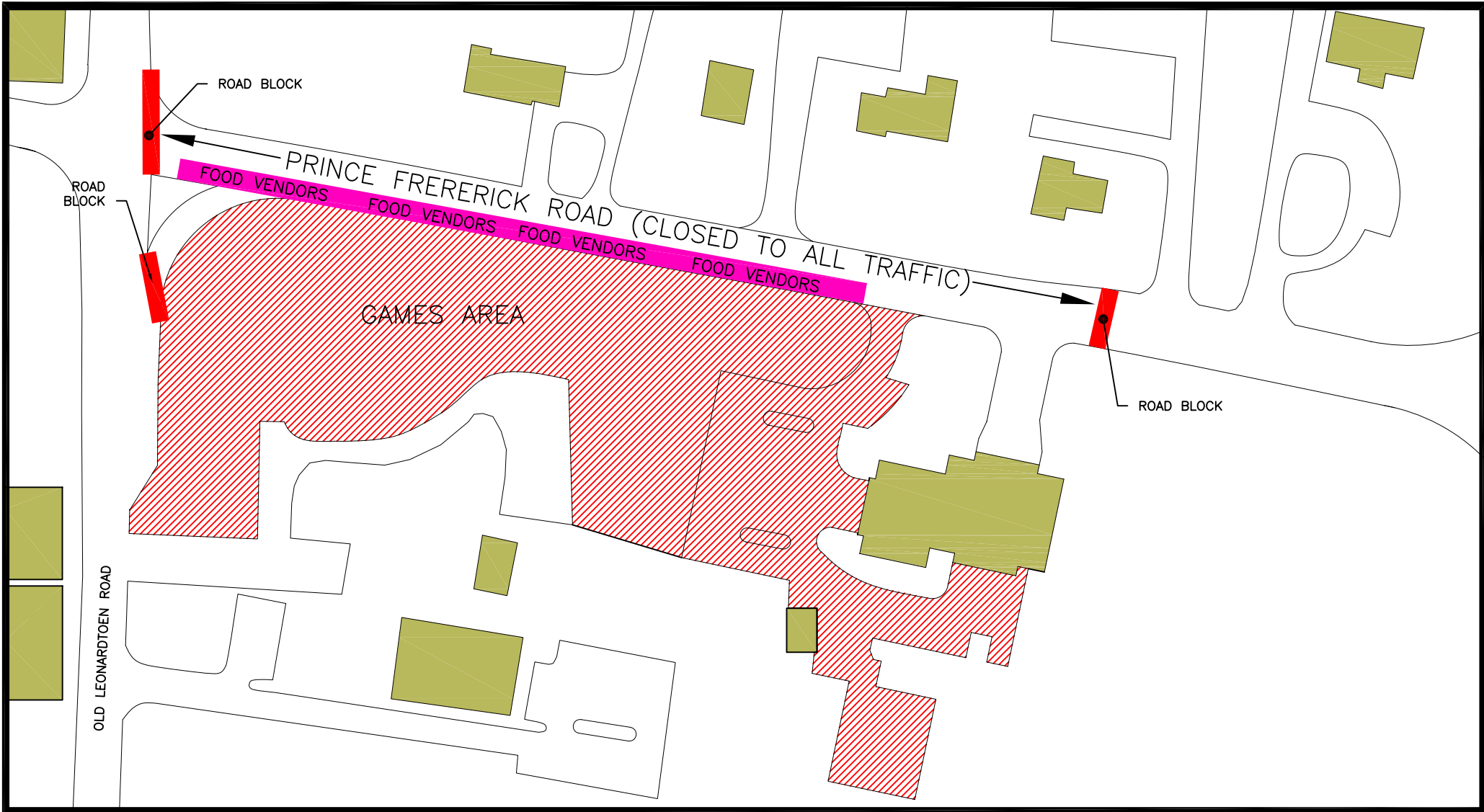

VENDOR AND GAMES LOCATIONS FOR THE
 62ND ANNUAL SOUTHERN MARYLAND VOLUNTEER FIREMEN'S CONVENTION

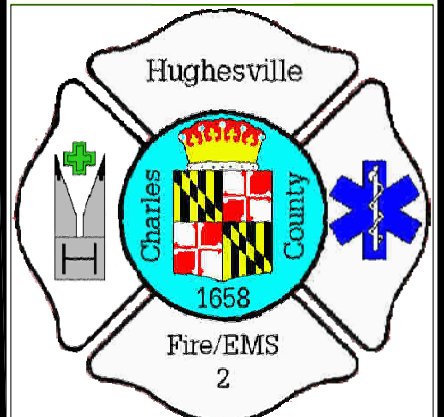

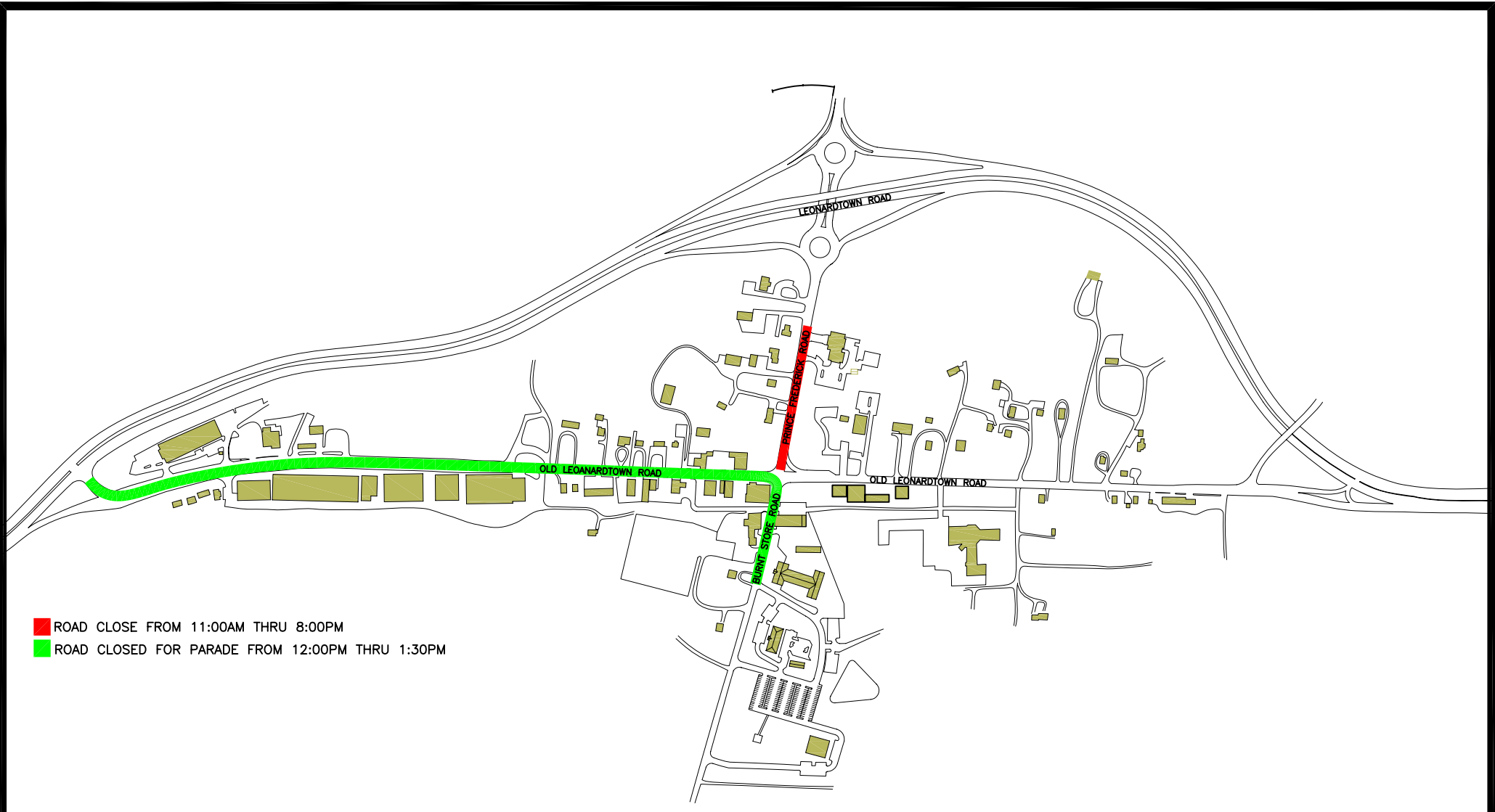

- ROAD CLOSE FROM 11:00AM THRU 8:00PM
- ROAD CLOSED FOR PARADE FROM 12:00PM THRU 1:30PM



ROAD CLOSURES FOR THE
62ND ANNUAL SOUTHERN MARYLAND VOLUNTEER FIREMEN'S CONVENTION

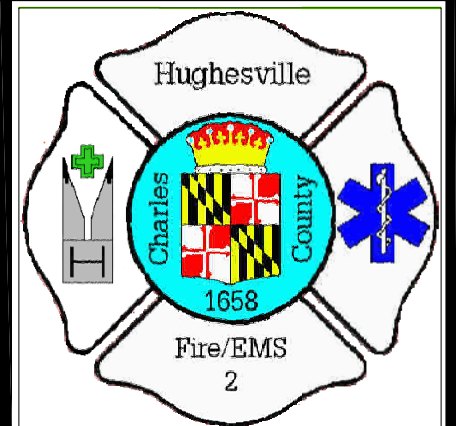

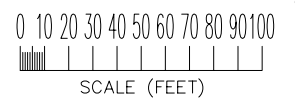
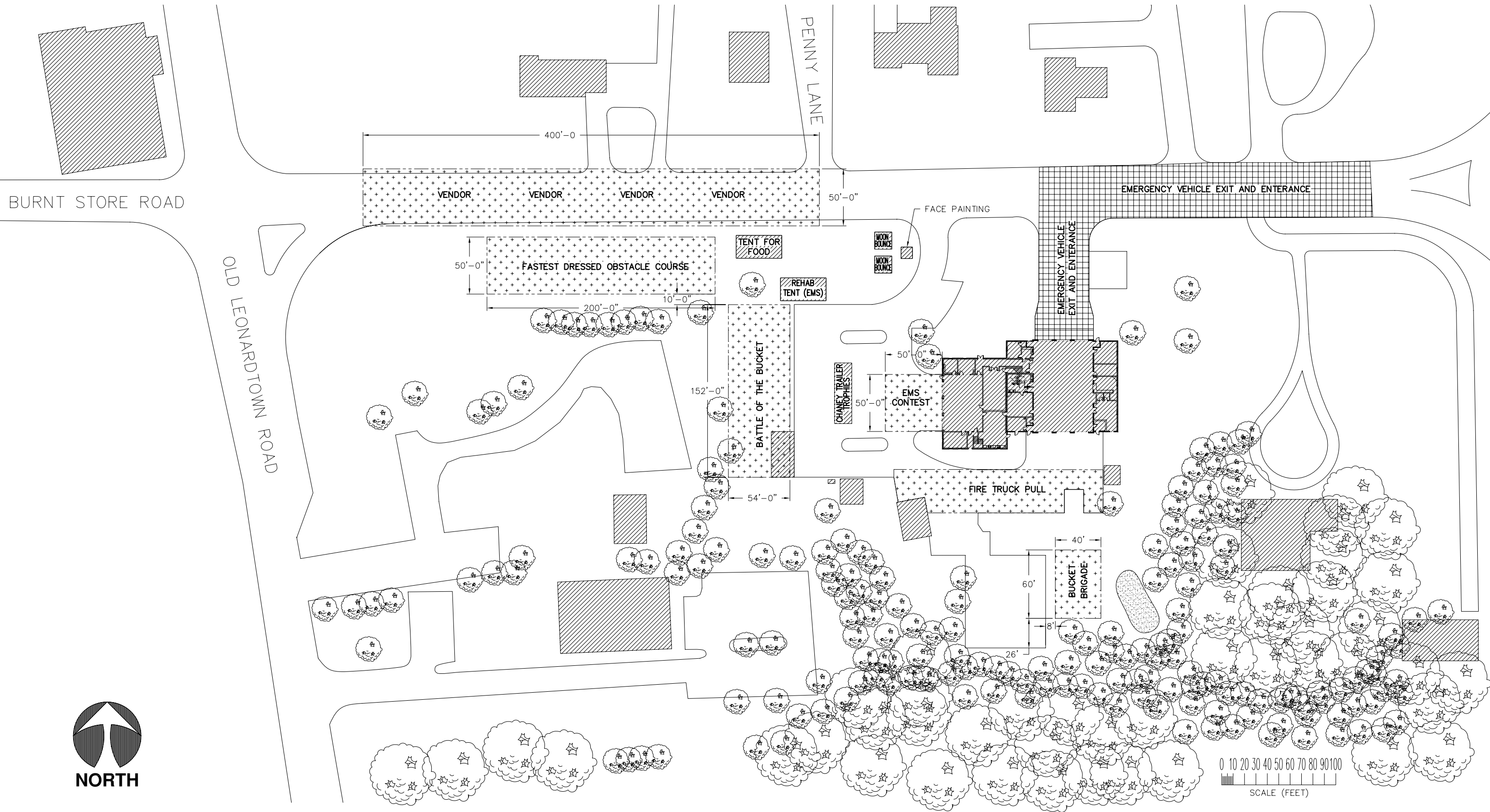

LAYOUT 62ND ANNUAL SOUTHERN MARYLAND VOLUNTEER FIREMEN'S ASSOCIATION CONVENTION

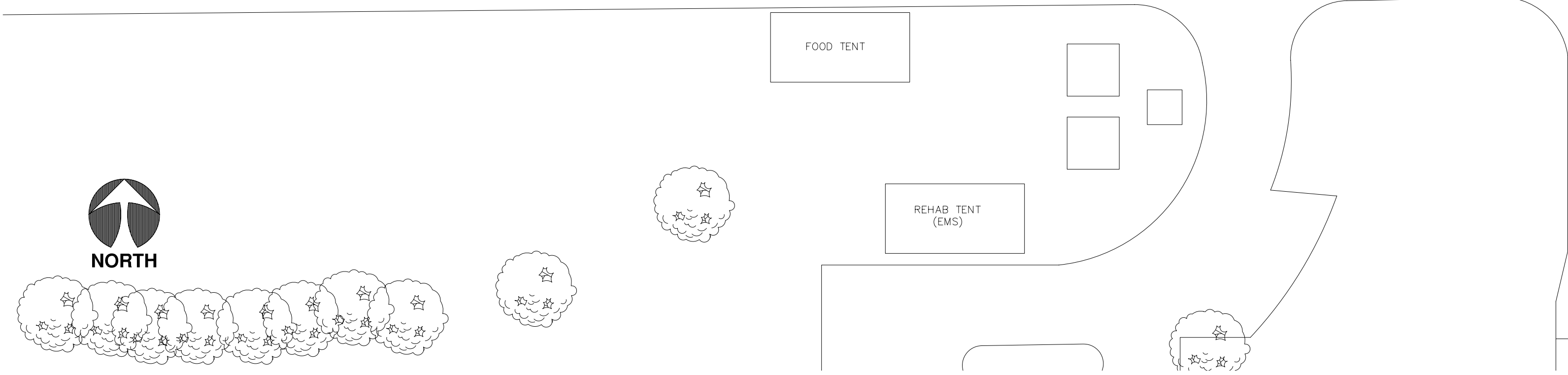
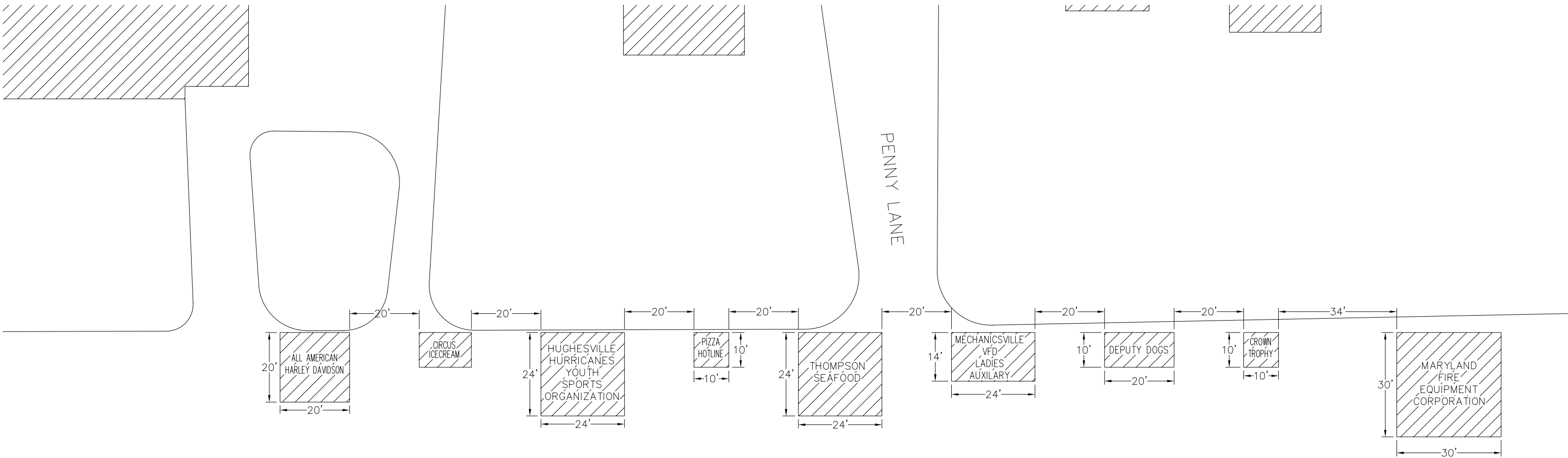

VENDOR LAYOUT 62ND ANNUAL SOUTHERN MARYLAND VOLUNTEER FIREMEN'S ASSOCIATION CONVENTION

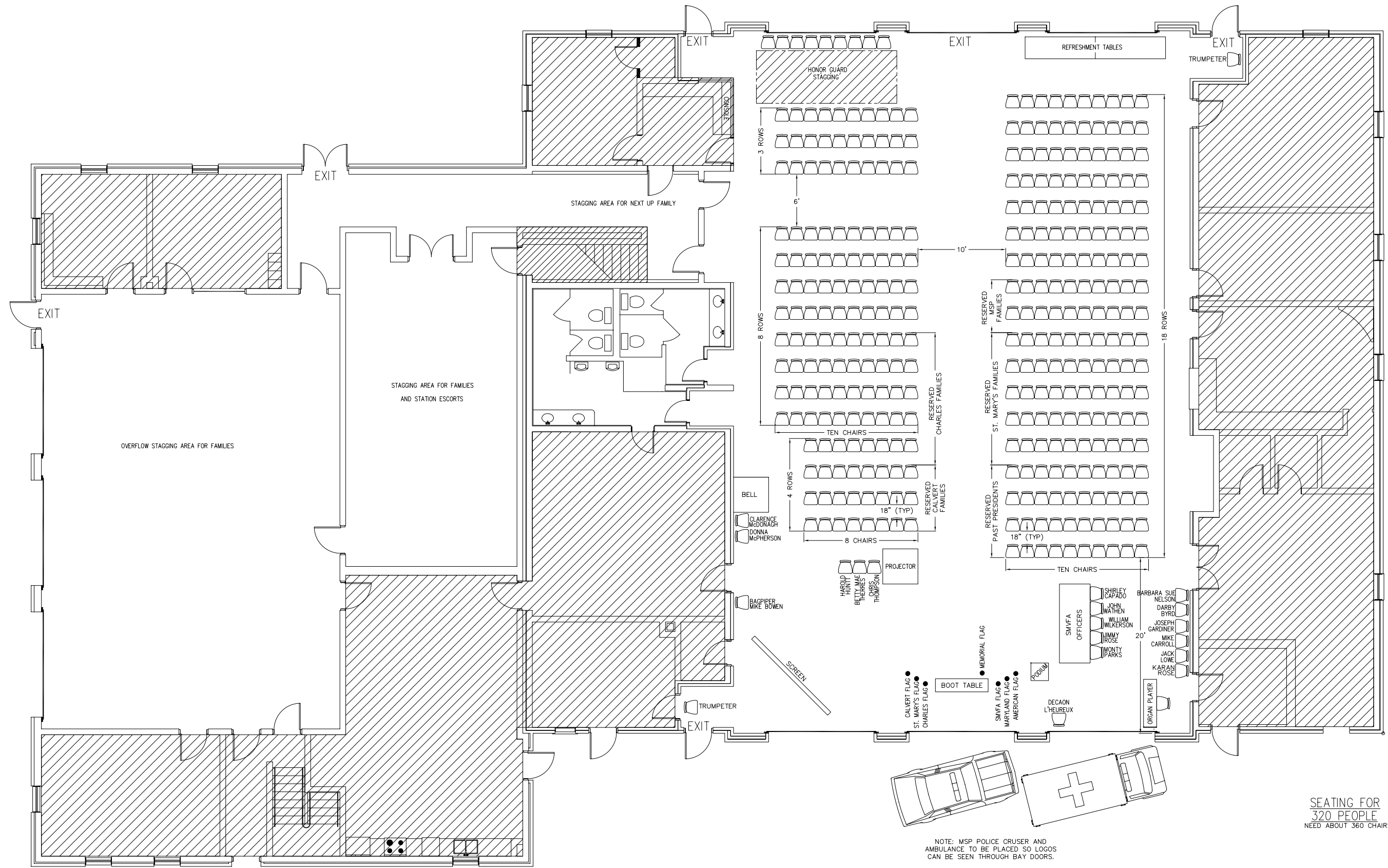

SEATING FOR 320 PEOPLE
NEED ABOUT 360 CHAIRS

NOTE: MSP POLICE CRUSER AND AMBULANCE TO BE PLACED SO LOGOS CAN BE SEEN THROUGH BAY DOORS.

62ND ANNUAL SOUTHERN MARYLAND VOLUNTEER FIREMEN'S ASSOCIATION CONVENTION MEMORIAL LAYOUT